

# Daily Coordination Meeting



# Daily Coordination Meeting

## General Topics:

- Red flags-change in personnel-people out for the Eid al-Fitr holiday.





SK  
Press test CW  
3/31  
From 17:00  
till 5:00





## UTILITY LEVEL MOD1

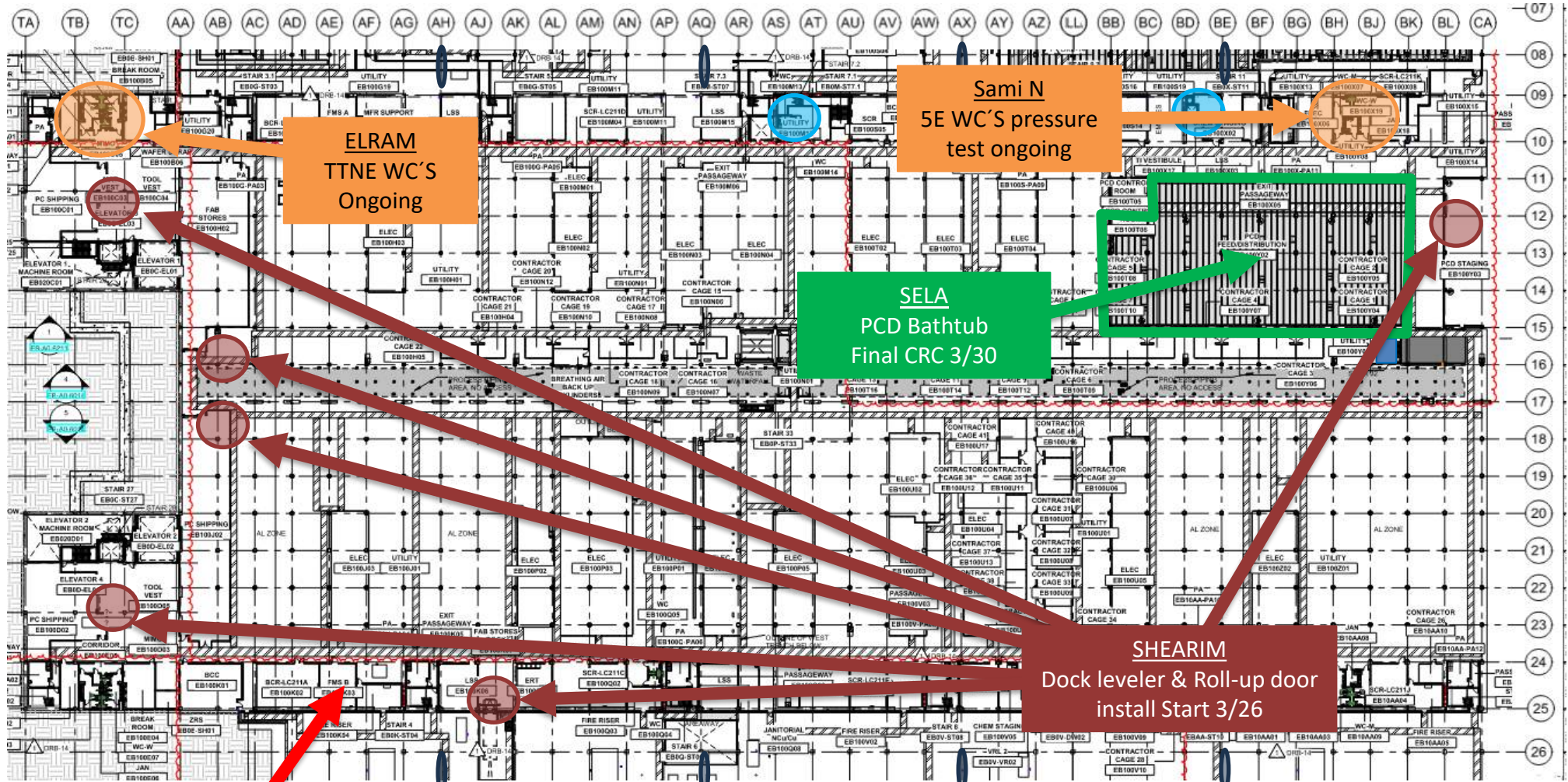

Carmel Duct  
FMS-B  
Removing scaffold  
3/30

ELRAM  
TTNE WC'S  
Ongoing

Sami N  
5E WC'S pressure  
test ongoing

SELA  
PCD Bathtub  
Final CRC 3/30

SHEARIM  
Dock leveler & Roll-up door  
install Start 3/26

ELRAM  
Stairs 7.1  
Chem stag  
TTNW OH door  
Break room E



## SUT 38.1 LEVEL

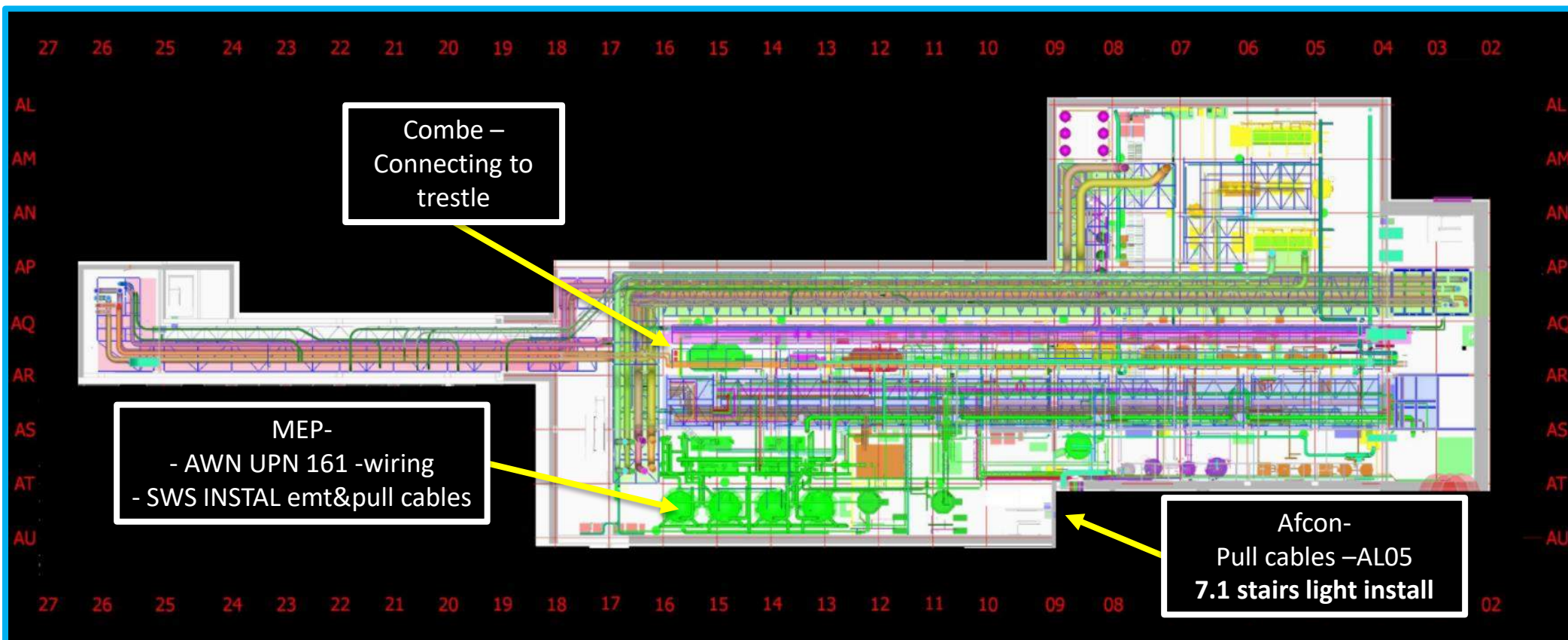



## SUT 38.1 LEVEL

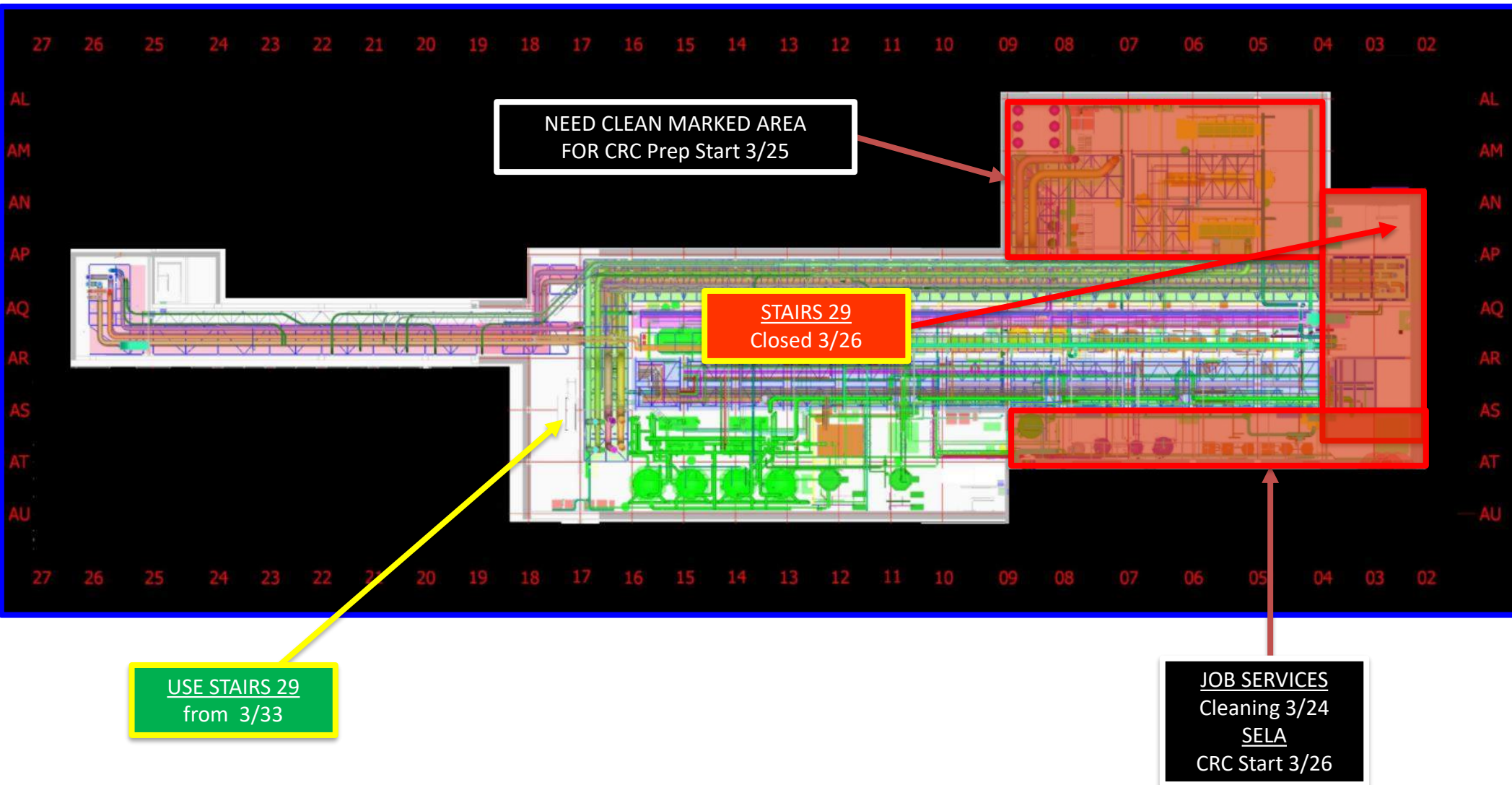



## SUT 38.2 LEVEL

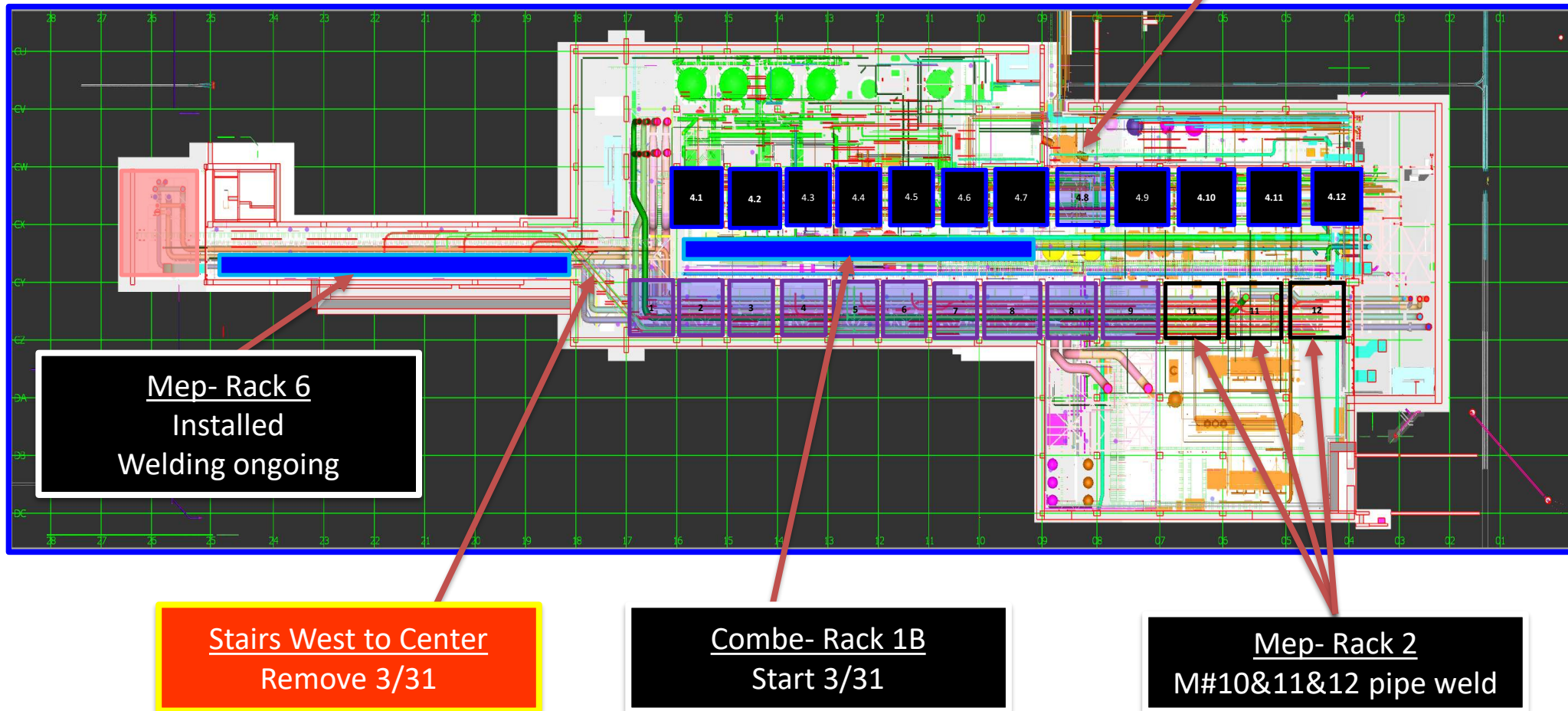



# SUBFAB BUILDOUT MOD 1

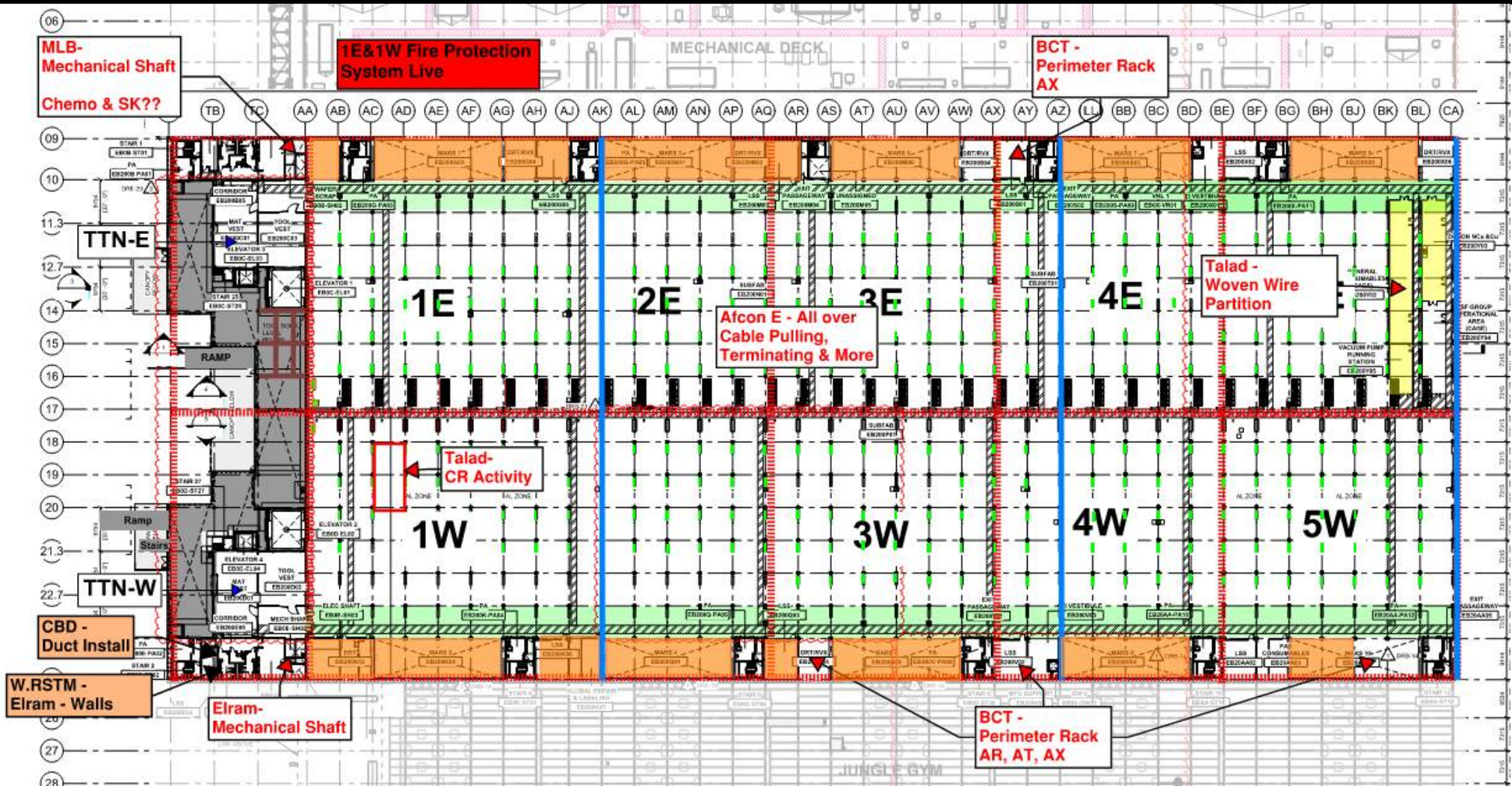



# SUBFAB CRC TOPCOAT

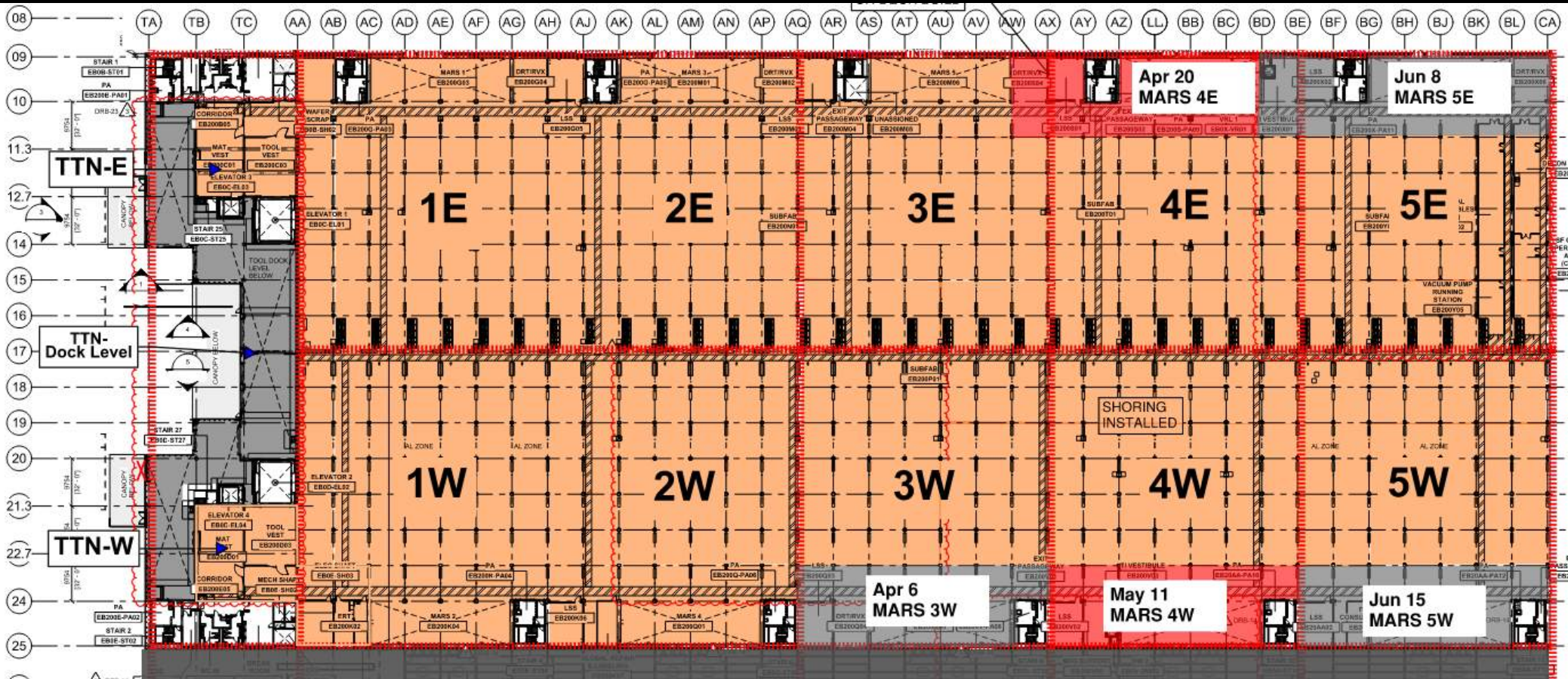



# BCT Pressure Test Tomorrow

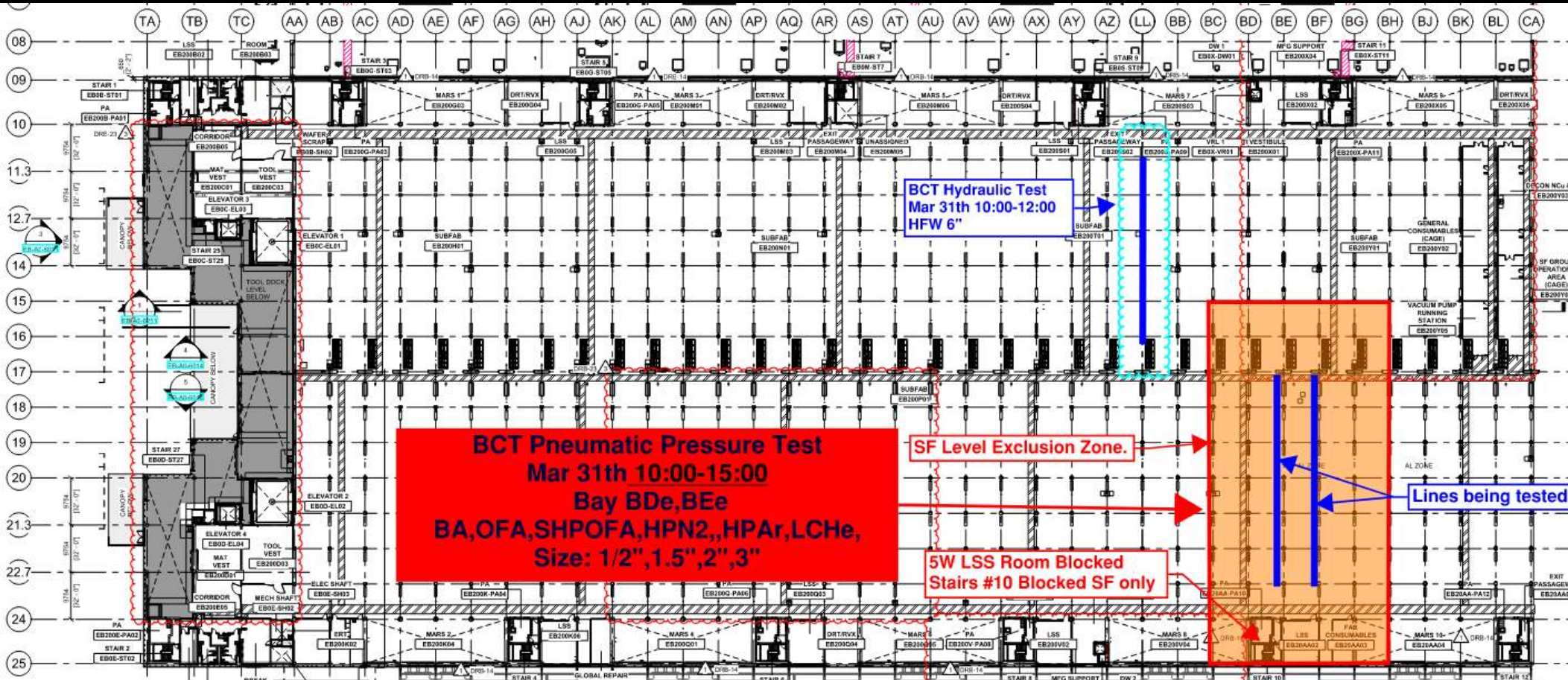



# SUBFAB BUILDOUT MOD 2

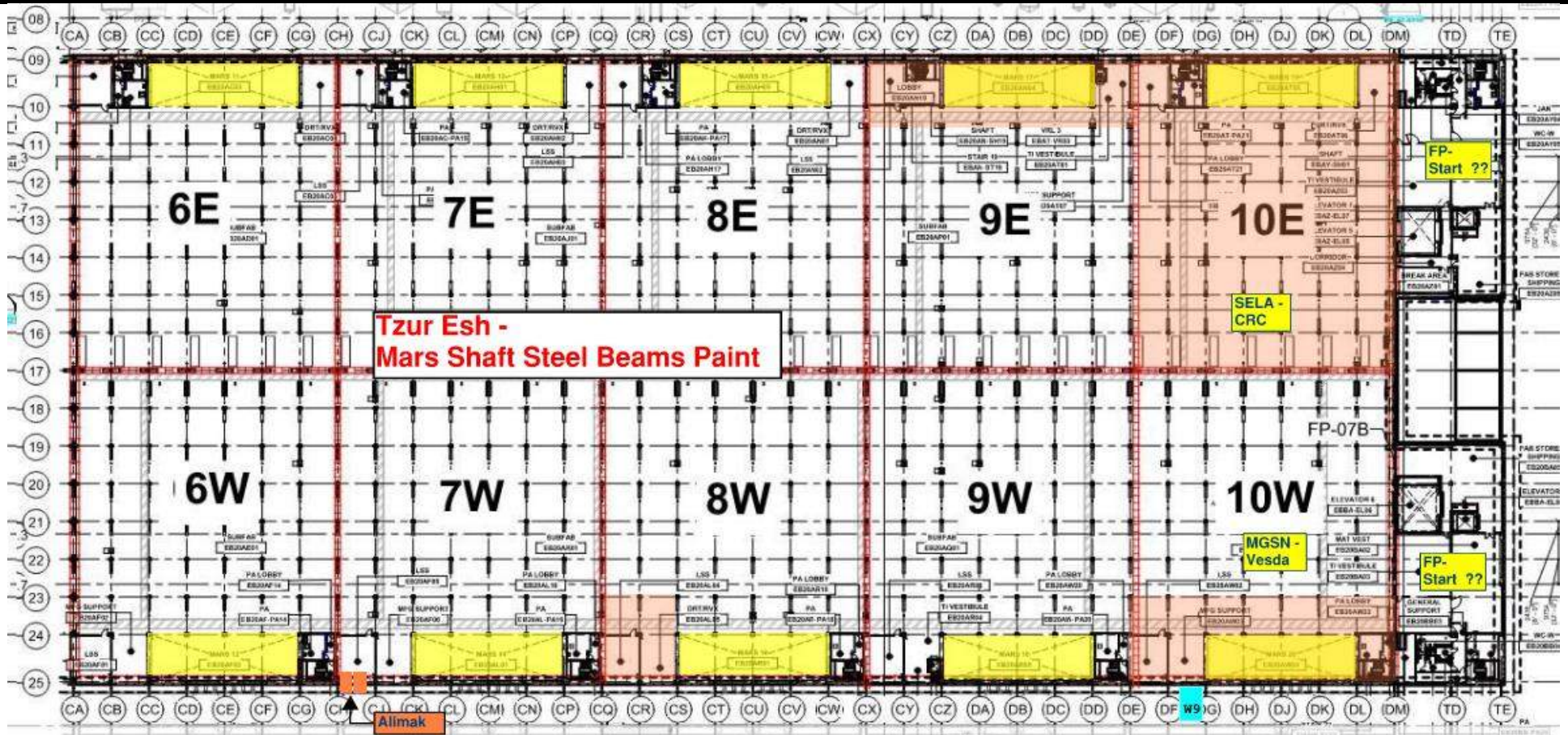



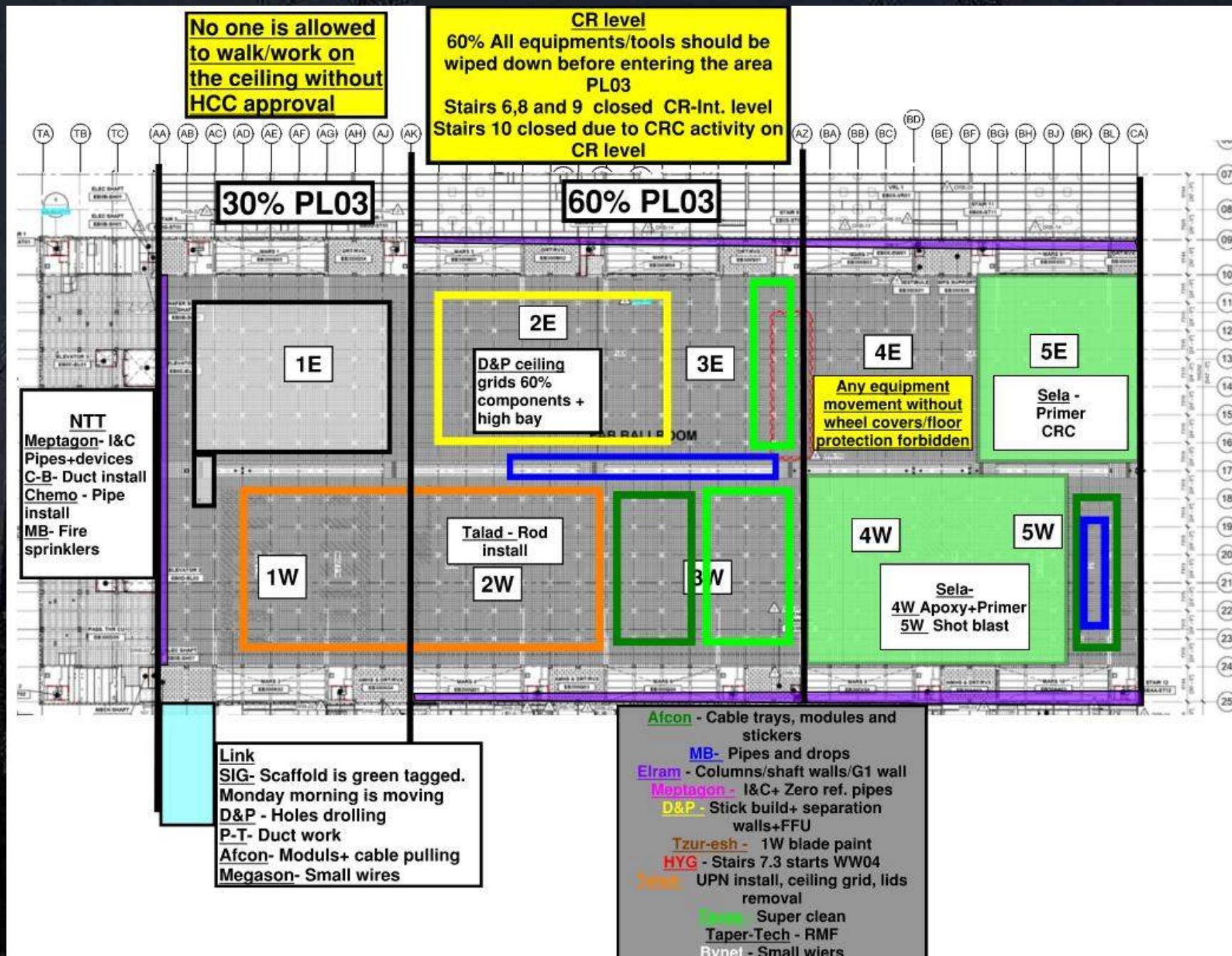



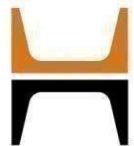

**Afcon** - Cable trays, modules and stickers

**MB** - Fire sprinklers

**Elram** - Gypsum/G1 wall

**Chemo** - Skids and pipes

**SK** - IA pipes

**Tzur-esh** - Paint+ touch ups

**WW** - Cat walk

**RPC** - 4DA/5DA FP

**Tavas** - Super clean

**Bynet** - Communication weirs

**Megasone** - Speakers

**Meptagon** - I&C

**Int. level**

60% All equipments/tools should be wiped down before entering the area PL03

**Int. level**

Do not cross/remove the fence in 60%-100%

30%

60%

**NETT**

Chemo- Racks+pipes ongoing

Megasone - Small wires+Speakers

RPC- FP rack/girts

**NWTT**

Chemo- Racks

MB- FS install

AFA- Vesda

RPC- started FP racks

**WW/SN** - Handrail install  
**Elram** - G1 metal sheet

**TMT** - Penetrations for Afcon, D&P, Talad and MB

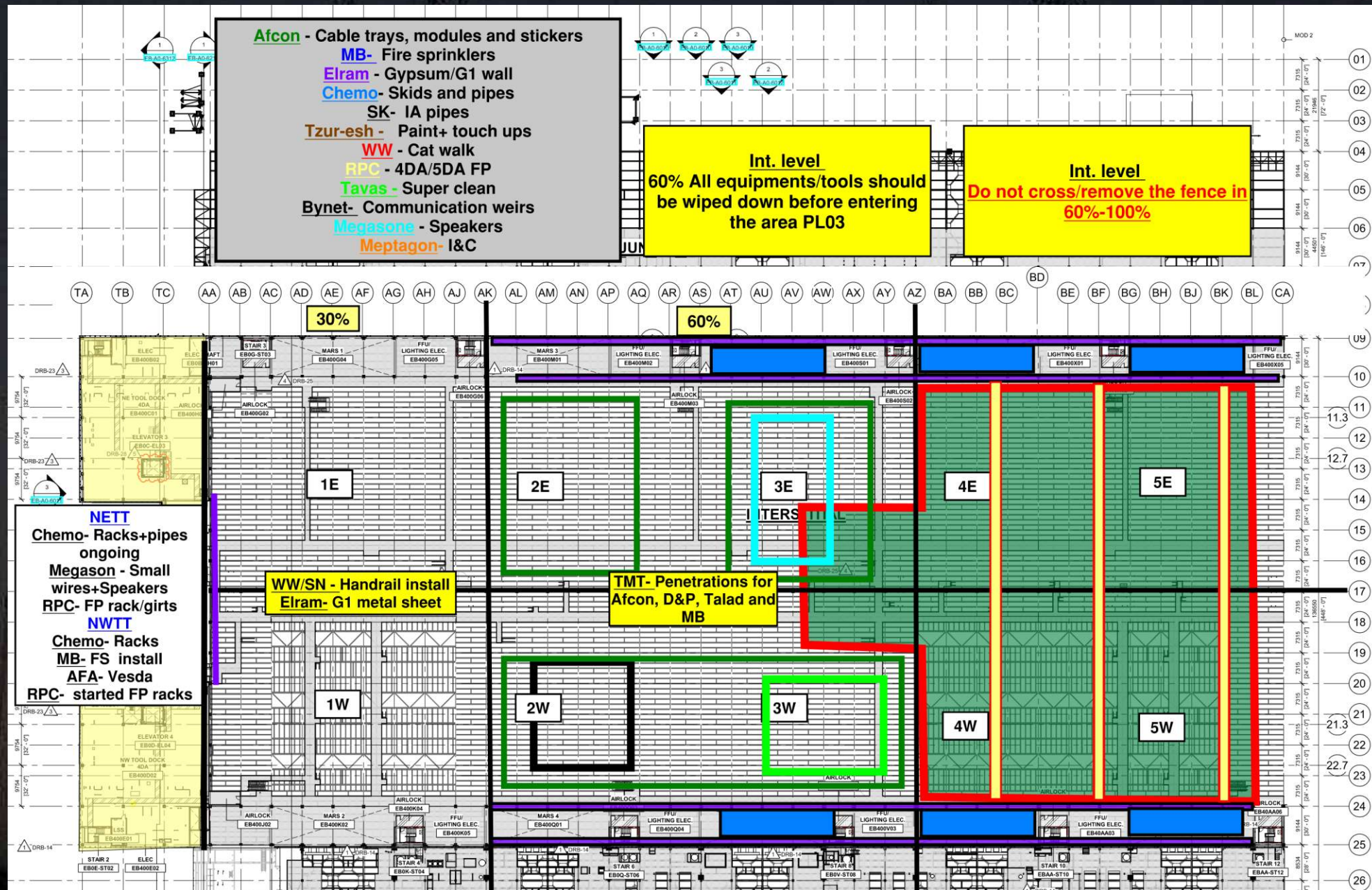



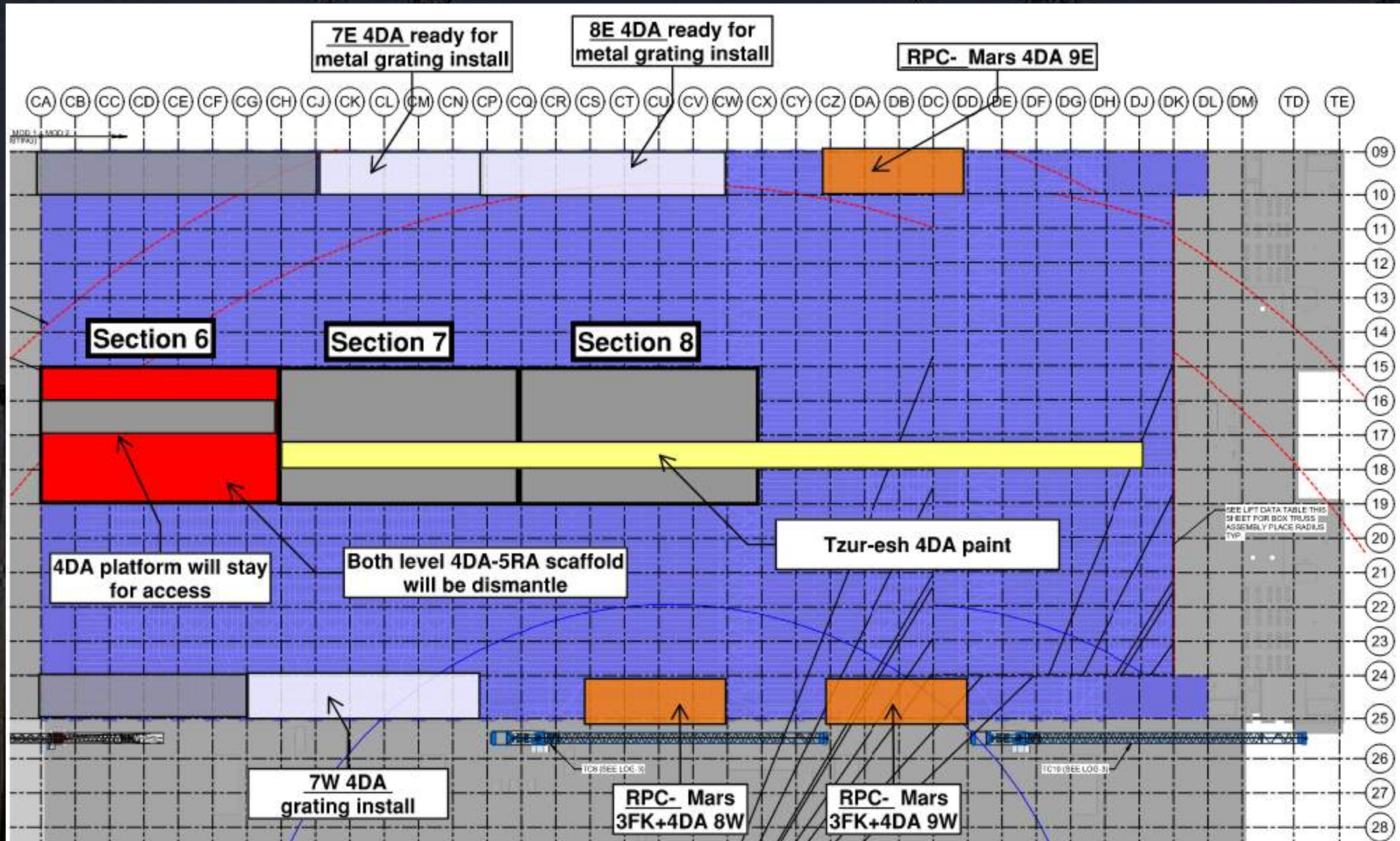



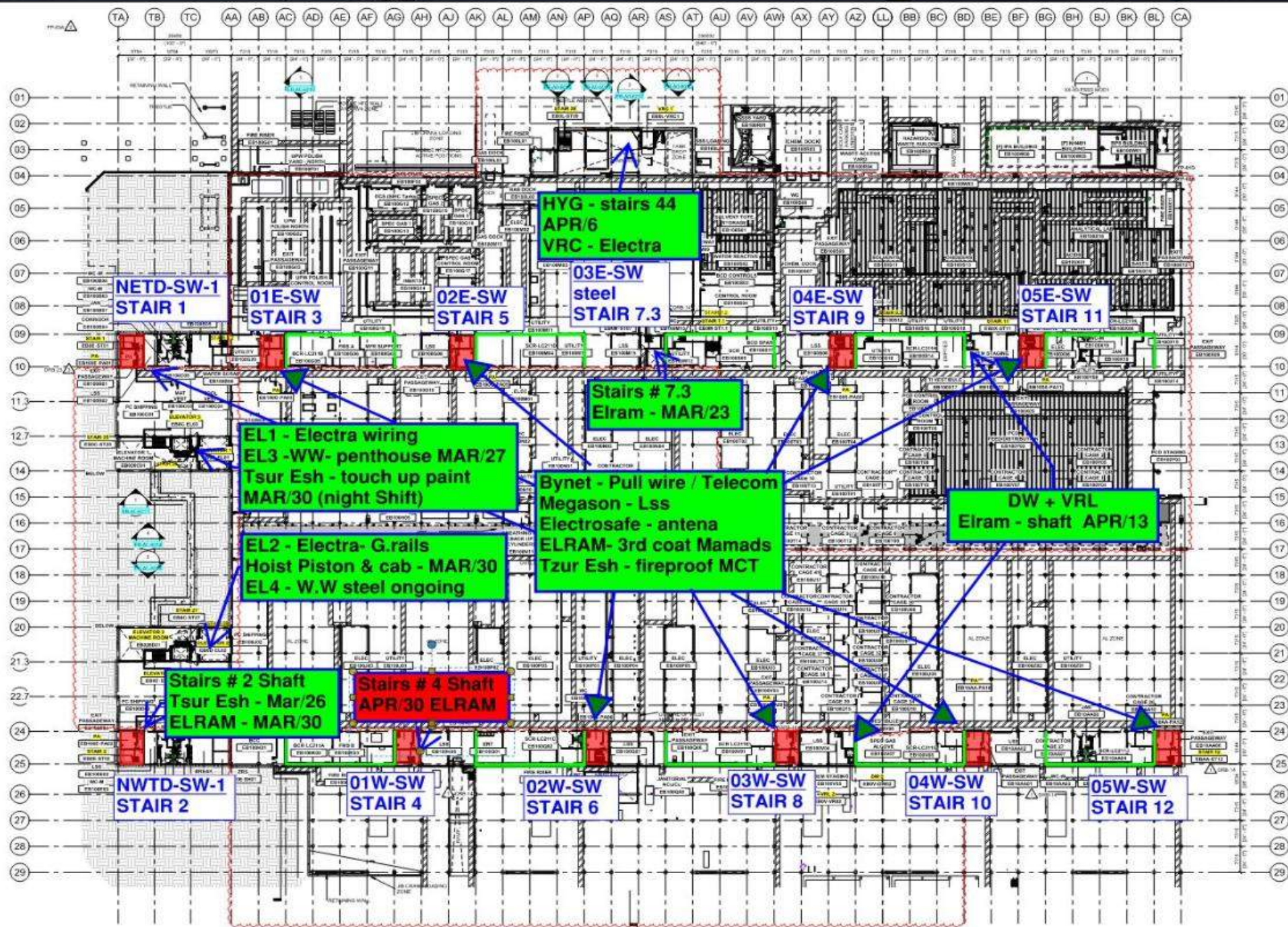



# Siding Penetration Request Form

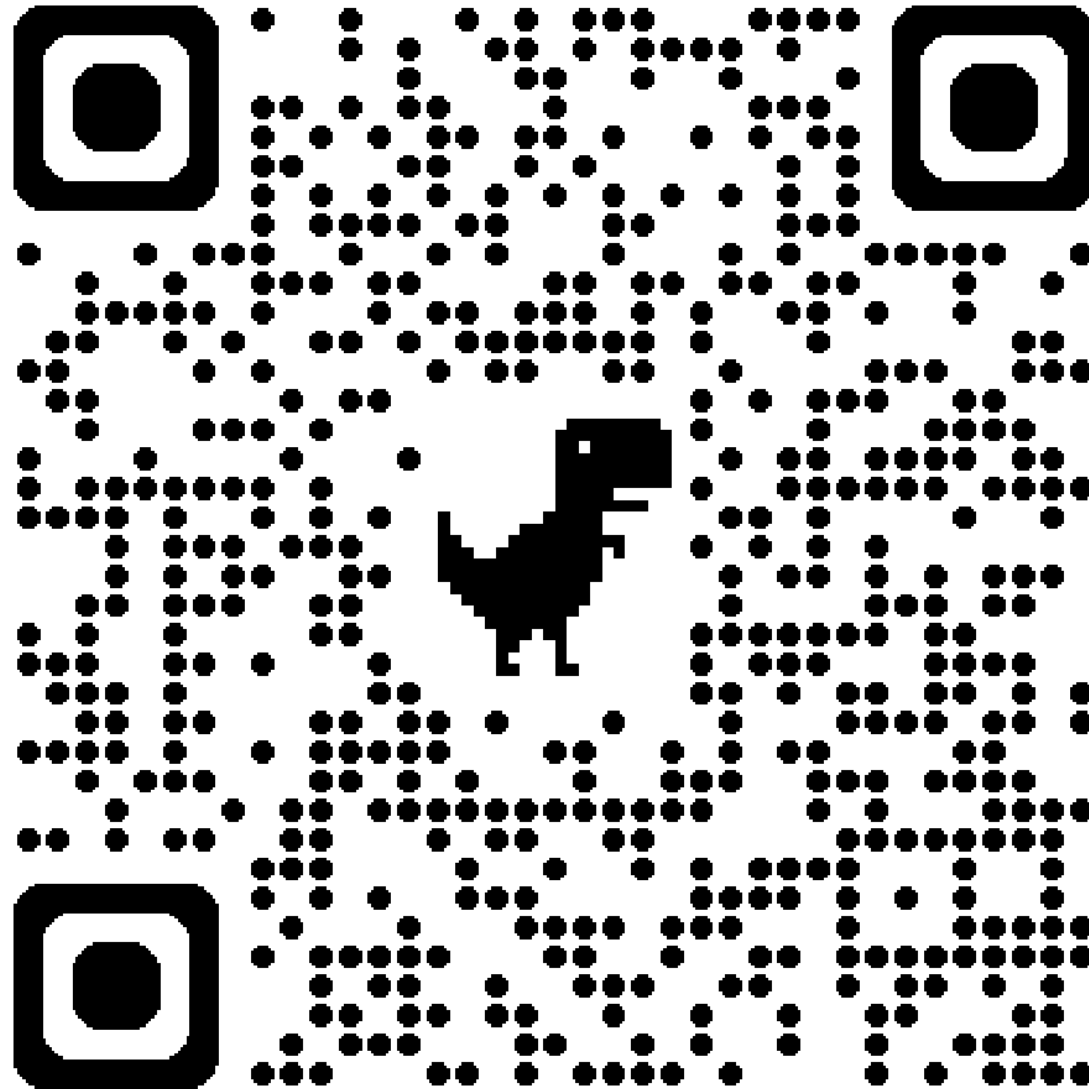

Subcontractor must fill out and submit all required cells in order to get a penetration cut through the siding.



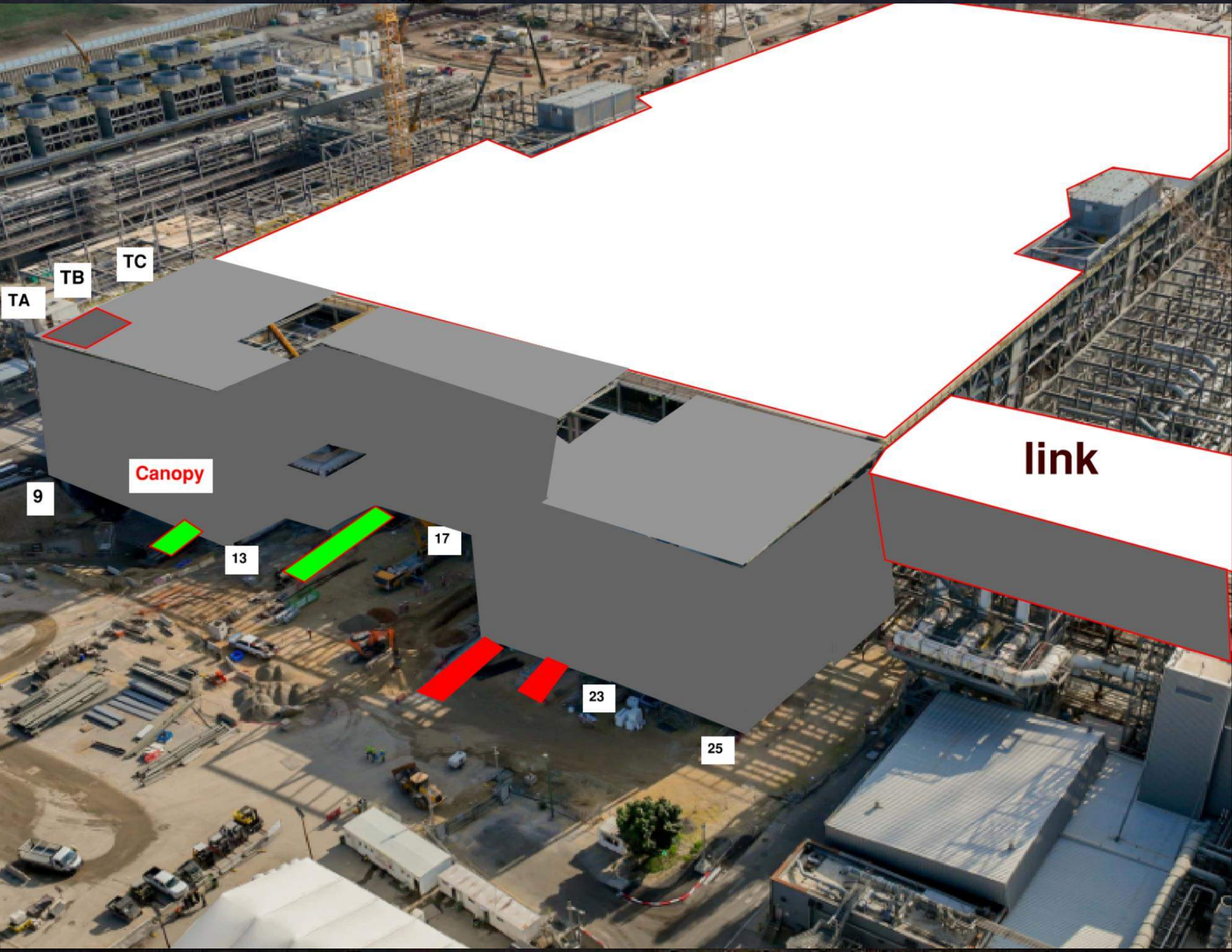

TA

TB

TC

Canopy

9

13

17

23

25

link







## MOD 2 EASTSIDE GIRTS/SIDING



2752/ 2751	2742/ 2741	2732/ 2731	2722/ 2721	2712/ 2711	2552/ 2551	2542/ 2541	2532/ 2531	2522/ 2521	2512/ 2511	2502/ 2501
---------------	---------------	---------------	---------------	---------------	---------------	---------------	---------------	---------------	---------------	---------------

READY FOR GIRTS	
INSTALLING GIRTS	
READY FOR PANELS	
PANELS INSTALLED	



## MOD 2 WESTSIDE GIRTS/SIDING

READY FOR GIRTS 

INSTALLING GIRTS 

READY FOR PANELS 

PANELS INSTALLED 







220  
Crane

450 Crane to set  
elevator 2 cab  
sunday morning  
30/03



# PSSS.1

Utility Level  
1YA

PSSS Roof  
2SA

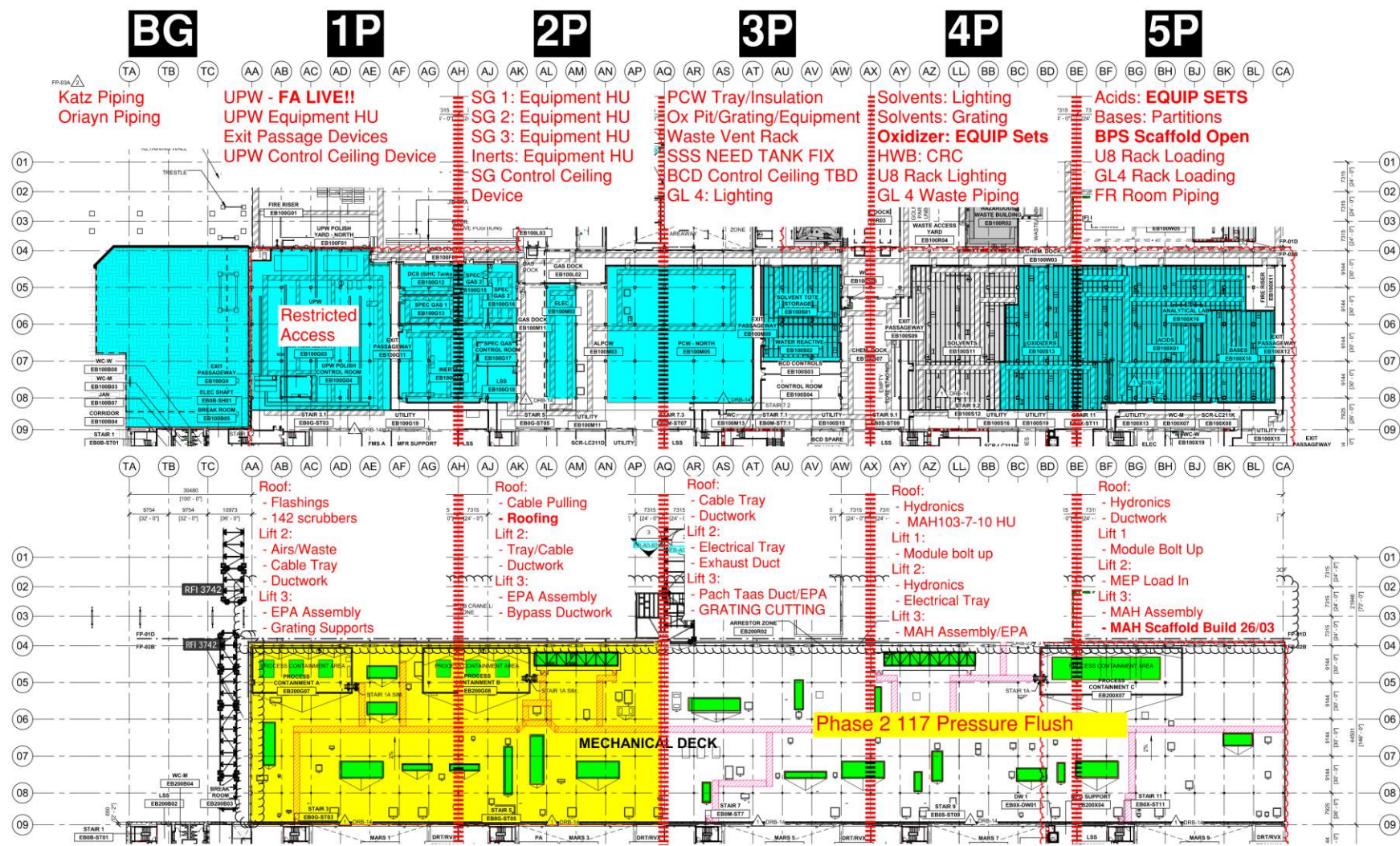



# PSSS.2

Utility Level  
1YA

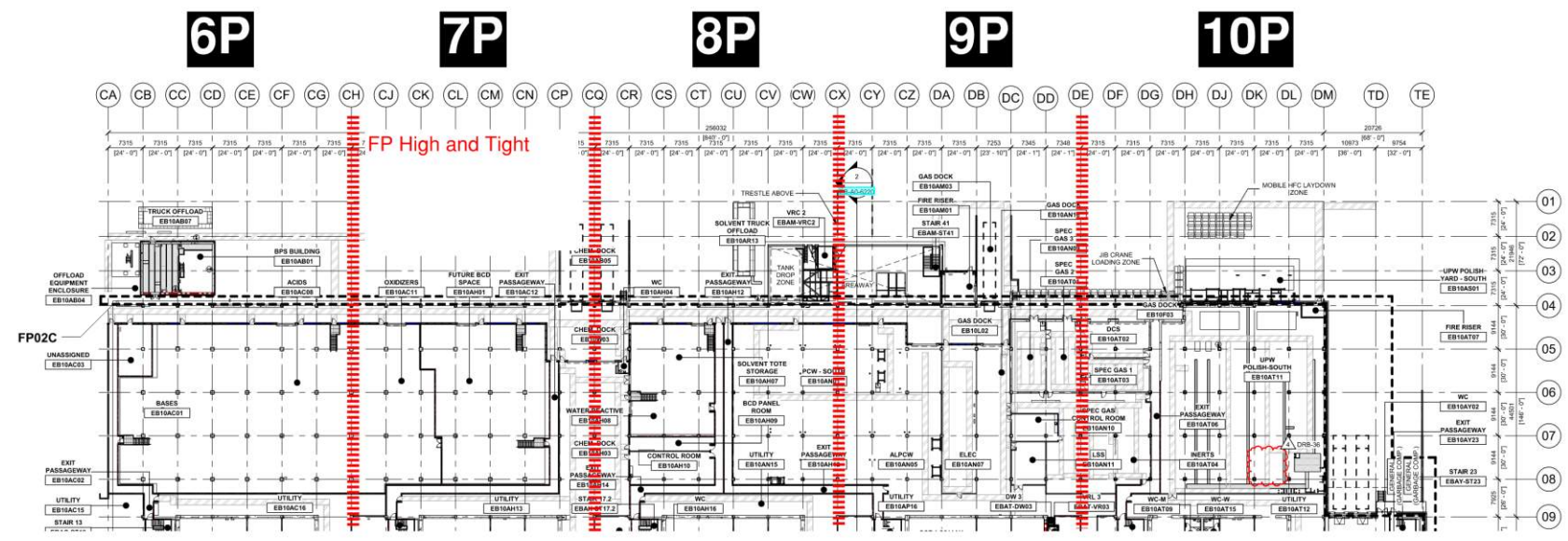

PSSS Roof  
2SA

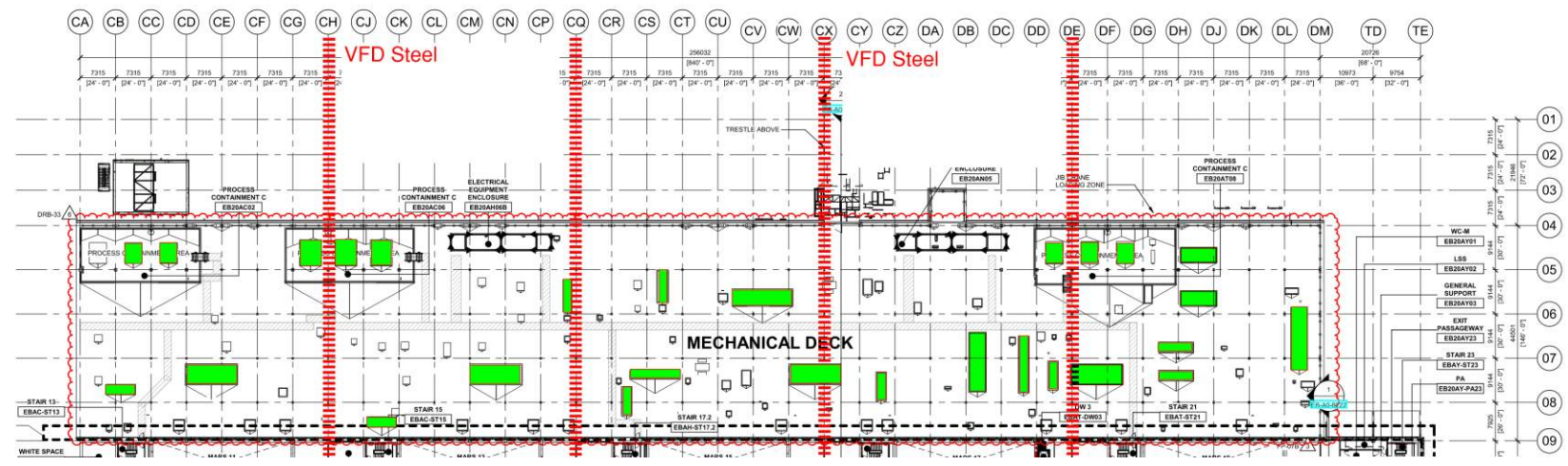



# PSSS Pressure Testing

Utility Level  
1YA

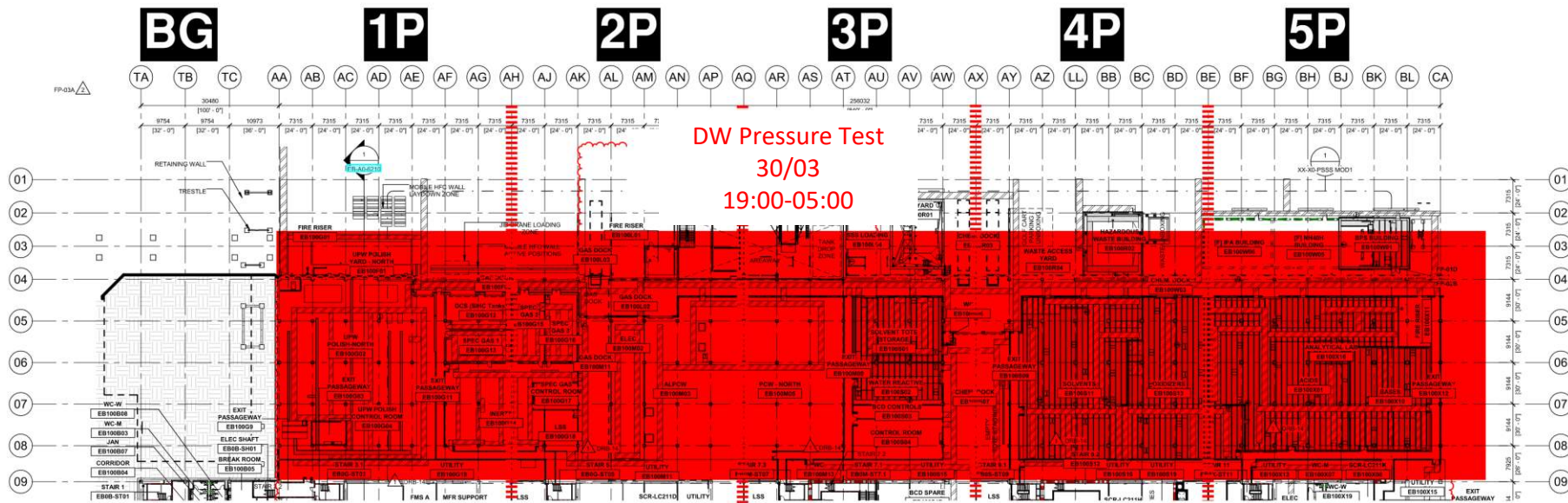



# BGY GN2 Bursting Zone Tomorrow





# MOD2 VFD Delivery





## WJG – UL

\* Pach Taas - fixing rejects on UPN 138

\* Carmel Bidud - connection of last duct to AH  
\* Pach Taas - completion of spools and lindapters on UPN 138

\*Stage design - erection of Pach Taas scaffold  
\*Afcon - Installation of lighting and cable pulling

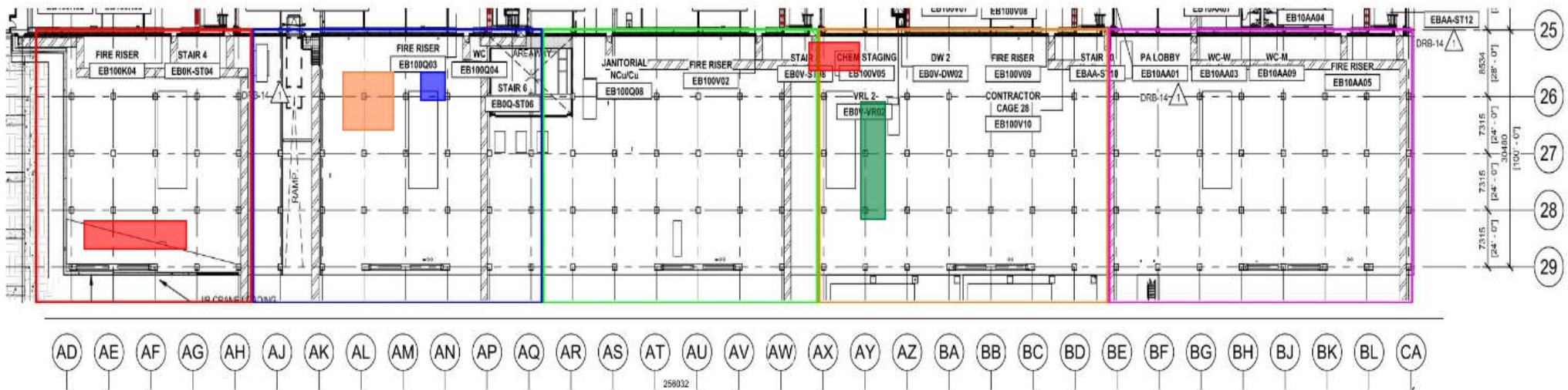



	<ul style="list-style-type: none"> <li>*Carmel bidud/Taper-tech - dismantling of planking for stiffeners (stopped due to lack of men power)</li> <li>* Chemo - performing to UPN 113</li> </ul>		<ul style="list-style-type: none"> <li>* Afcon - pulling cables to VFD</li> </ul>	<ul style="list-style-type: none"> <li>* Chemo - continuing insulation</li> <li>* SK and Afcon - performing connections to MAH</li> </ul>
--	---	--	---	---

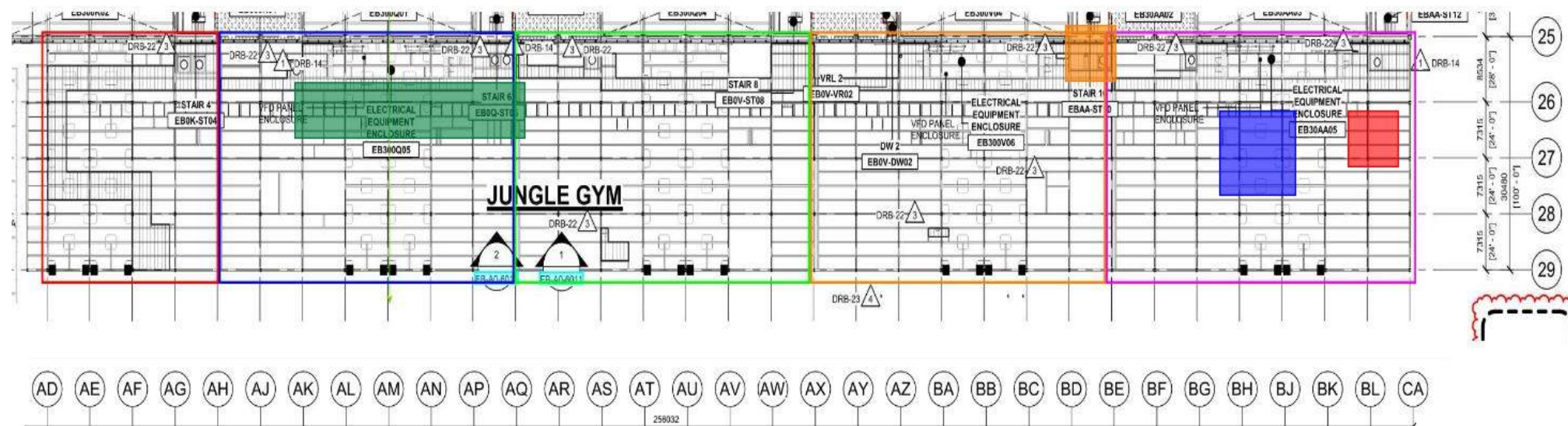



## WJG – Lift 3

			* Pach Taas - working on installation of bypass ducts	* SN -moving gratings and installing handrails
--	--	--	---	--







CUB 1 6 working days to room ready







# CUB 1

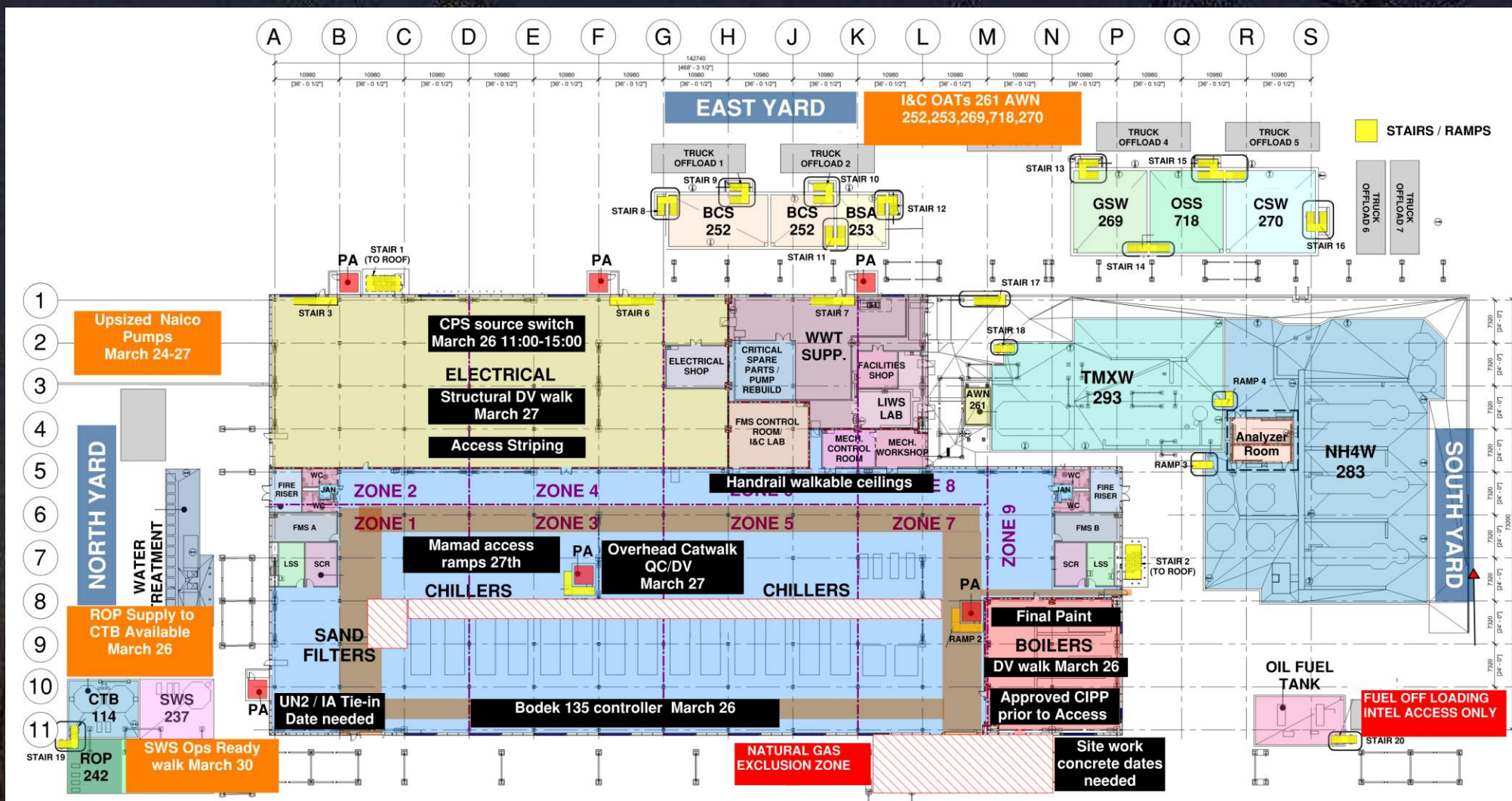



# CUB 1 – EXTERIOR/ROOF

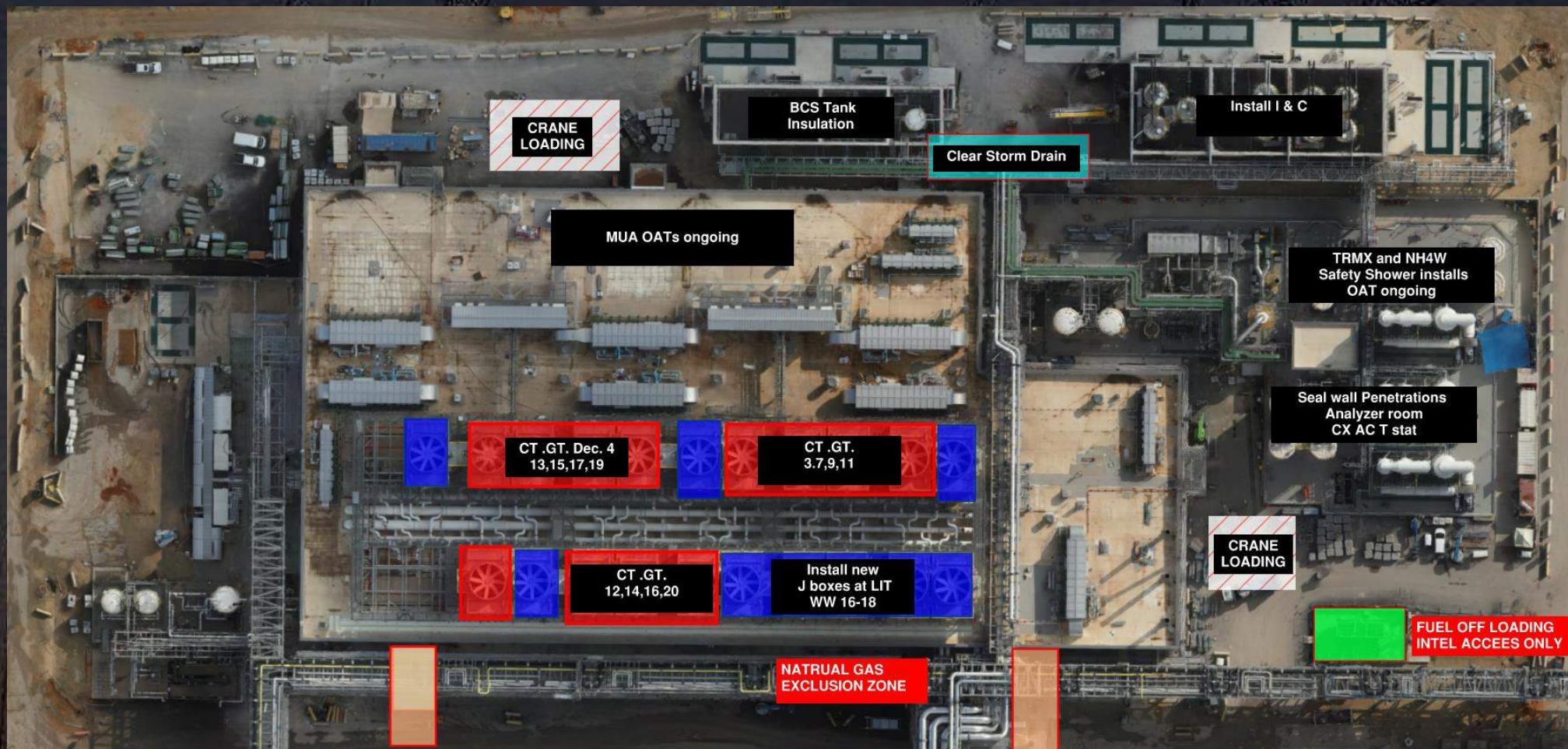



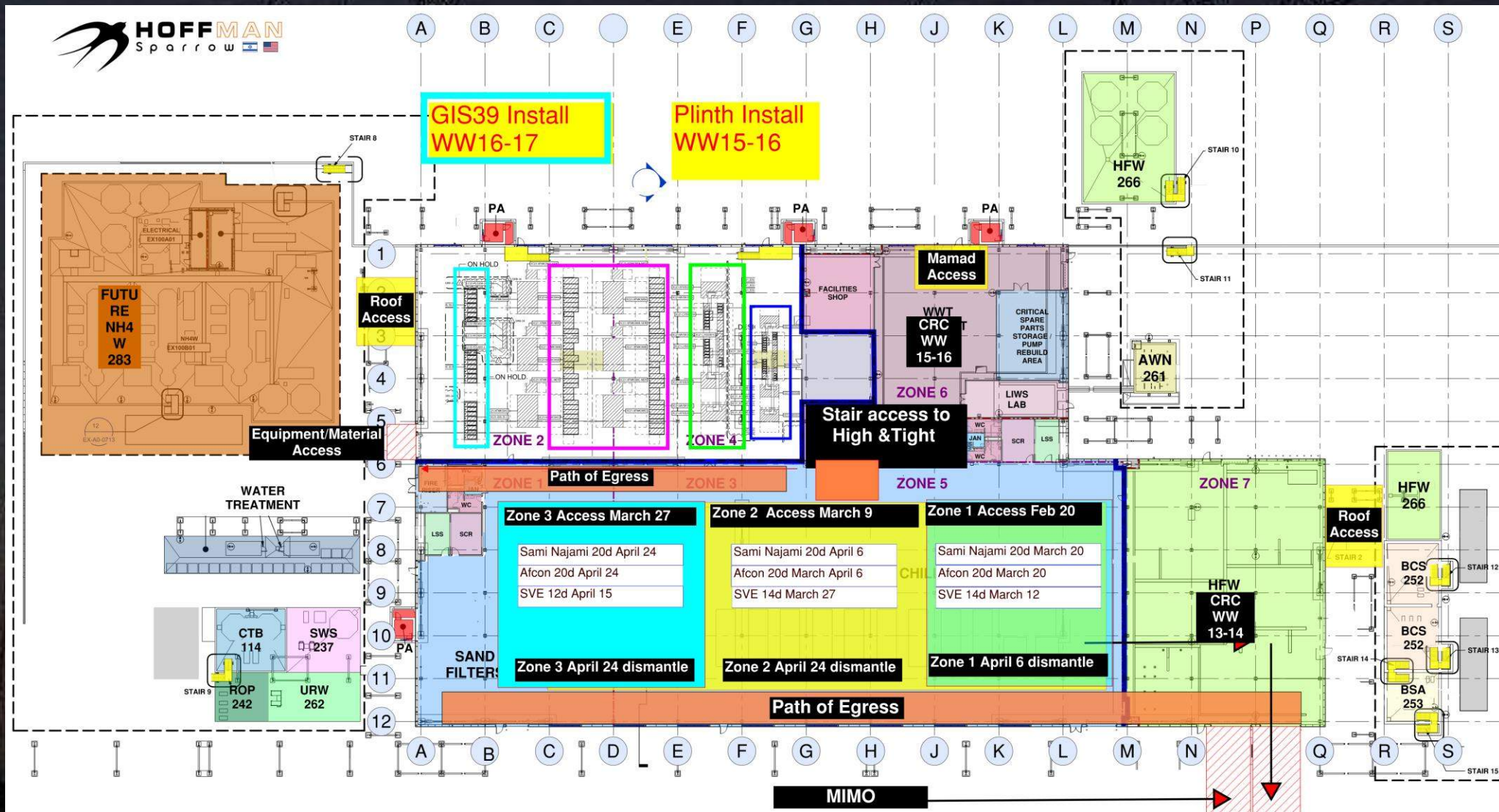



# CUB 2 – EXTERIOR/ROOF









# Daily Coordination Meeting

Site Logistics

North

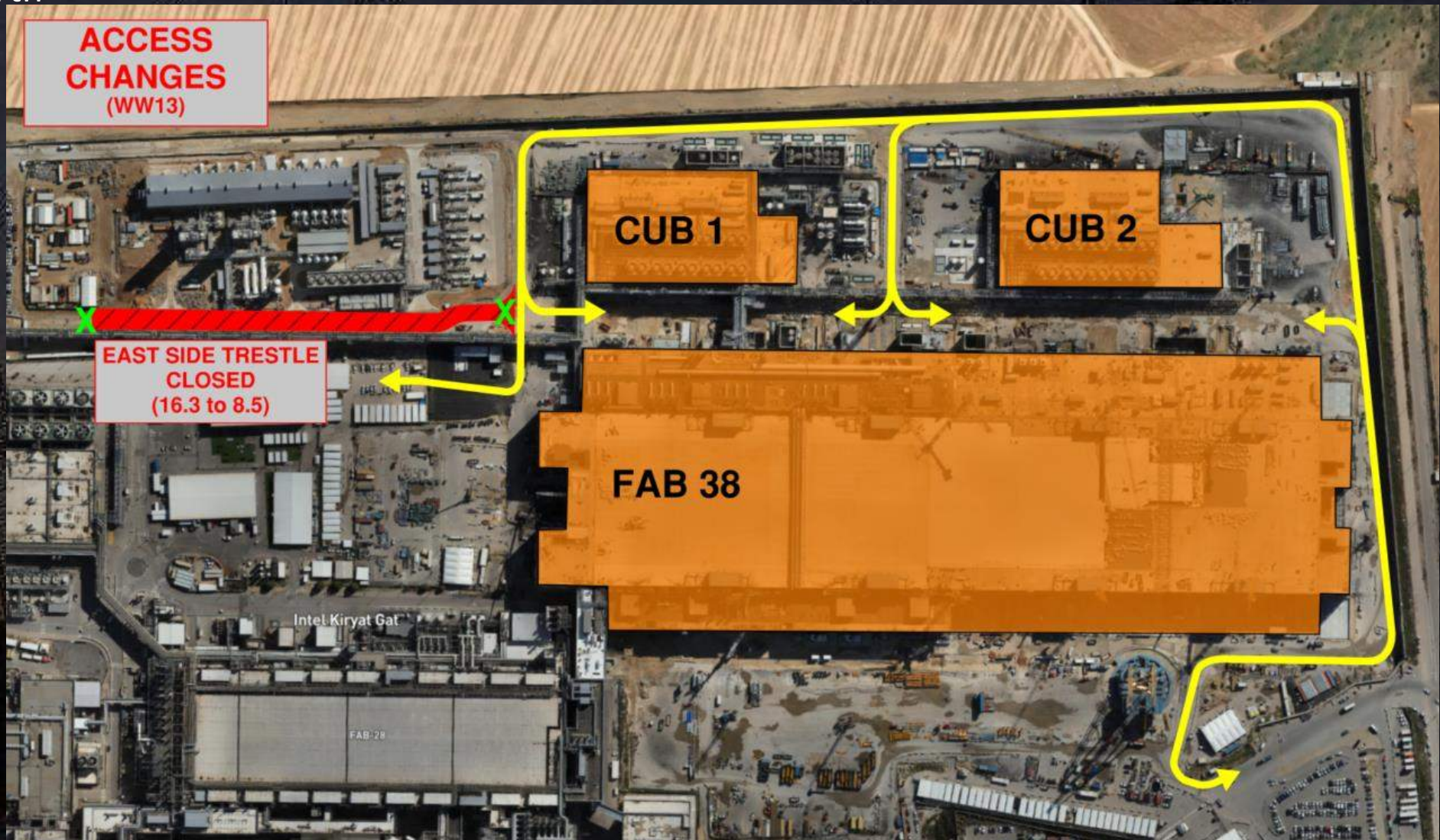





**HOFFMAN CONSTRUCTION COMPANY**



# Daily Coordination Meeting

Site Logistics  
North







HOFFMAN CONSTRUCTION COMPANY



# Daily Coordination Meeting

Site Logistics  
South





# Daily Coordination Meeting

## MAMAD Locations

MAMAD LOCATIONS (19-March-2025)

■ LARGE  
■ SMALL  
■ BUILDING

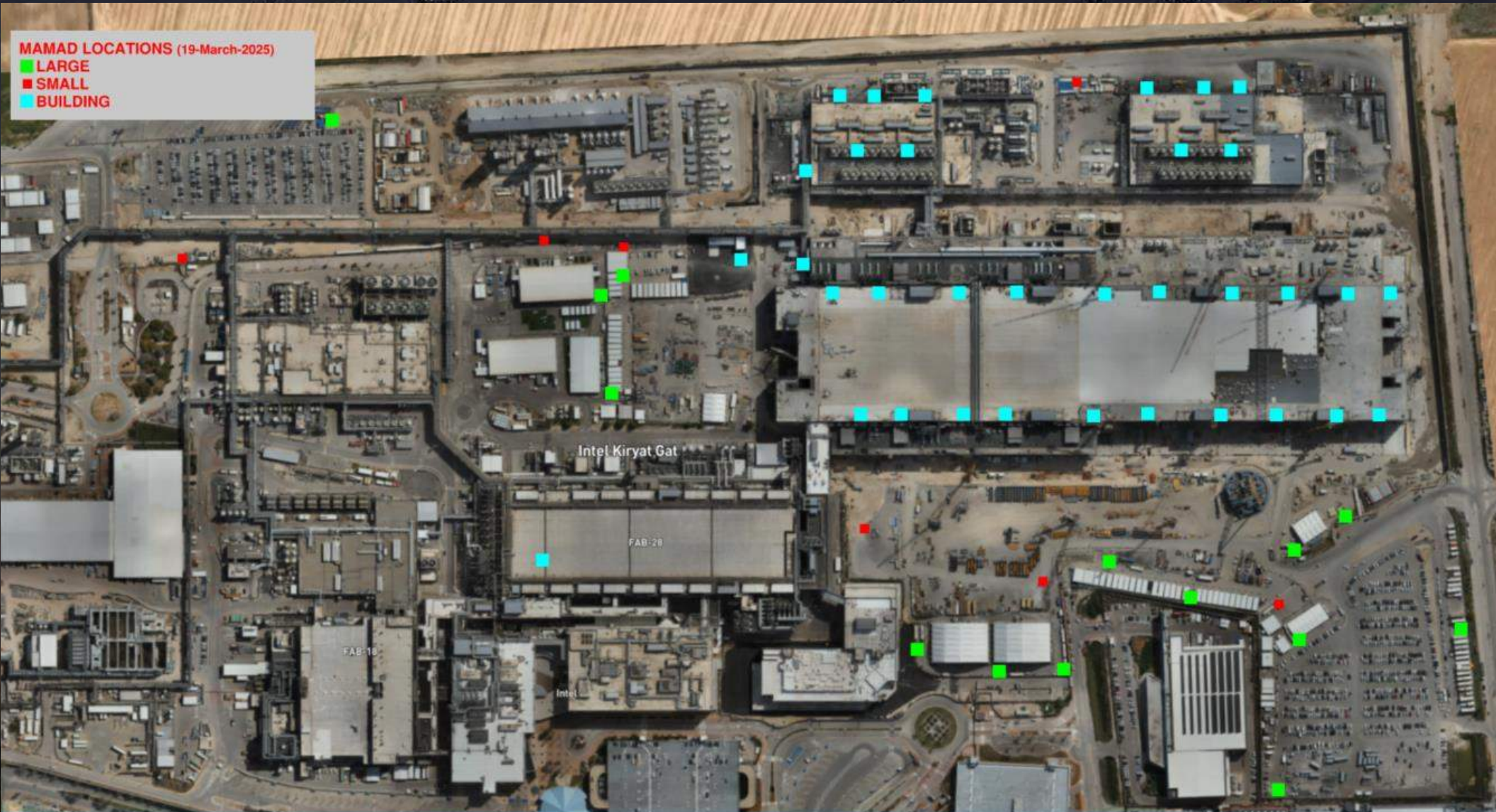



## The Importance of Safe Material Handling

- Proper handling minimizes accidents and injuries.
- Using four people ensures even weight distribution, reducing strain and injury risk.
- Correct lifting techniques and communication are essential.
- Ensure the cart and equipment are in good condition.
- Be mindful of obstacles and hazards. Make sure no part of your body is at risk and that you are not in danger of pinch point.
- Synchronize movements for smooth, safe transport.

**Safe material handling with proper planning and teamwork ensures efficient, injury-free tasks.**



# Daily Coordination Meeting



14:00 Sign In